



# Christmas In The Heart of Germany

November 29, 2012—December 7, 2012

**GERMANY**  
Frankfurt (5) - Miltenberg - Wertheim - Rothenburg - Bamberg - Nuremberg - Prague (2)  
**CZECH REPUBLIC**

① = Overnights  
● = Start City  
● = End City

**Pricing**

**Category E - Request**  
Riverview, Water Level

**Category B - \$2,043 / person**  
Wall to Wall Panoramic Window w/Sliding Glass Doors, Deck 2

**Category A - \$2,079 / person**  
Wall to Wall Panoramic Window w/Sliding Glass Doors, Deck 2

**Category P - \$2,150 / person**  
Wall to Wall Panoramic Window w/Sliding Glass Doors, Deck 2

Prices are based on double occupancy

## River Cruise

8 Days from  
Frankfurt to Prague



NEW 2012  
Avalon Visionary Ship

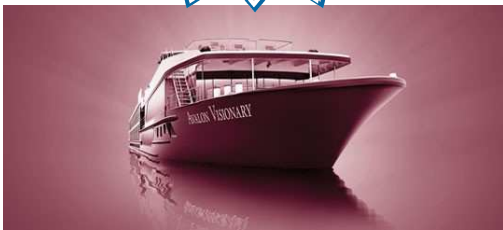
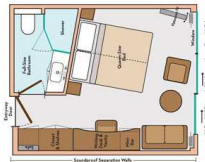

### Itinerary

Day 1	Arrive in Frankfurt, Germany (Embarkation)
Day 2	Miltenberg - Wertheim
Day 3	Würzburg. Excursion to Rothenburg
Day 4	Bamberg
Day 5	Nuremberg
Day 6	Nuremberg (Disembarkation) - Prague, Czech Republic
Day 7	Prague
Day 8	Prague

For more information please contact Ute:



143-147 East Main Street  
Lock Haven, PA 17745  
Phone: 570-748-6611 or 800-326-9342  
[www.nittanytravel.com](http://www.nittanytravel.com)

### INFORMATION

Costs include: 5 night river cruise from Frankfurt to Nuremberg - Breakfast, Lunch & Dinner included on the **Avalon Visionary**. 2 night stay at the Prague - Breakfast included. All port charges, taxes, & government fees.

PASSPORT NEEDED

Airfare and Transfers is NOT included in these rates.



TRAVEL DOCUMENTS:

*You are responsible for obtaining all travel documents as well as compliance with Customs and Immigration responsibilities. You will be required to comply with all security measures imposed by governments, which may change from time to time. We will endeavor to provide you with notice of measures which may affect you, but complying with any such requirements is your responsibility.*

***All travelers will need a valid passport.***

RESPONSIBILITY:

*Nittany Travel, operator of the tour herein outlined, its subsidiaries and/or its associated agents act as agents only for all services and disclaim any liability for property loss or damage and/or any loss of services which may be sustained on account, or arising out of, by reason of or while engaged on any tour whether due to ownership, maintenance use, operation or control of any automobile, bicycle, boat, vehicle, inn, common carrier, or otherwise caused by failure or delay or by any transportation company due to any cause whatsoever occurring during a tour under its management, sponsorship, procurement or otherwise. All tickets, coupons, and orders are furnished and issued subject in all respects to these terms and conditions and to any and all terms and public carriers for whom Nittany Travel acts solely as agent. Nittany Travel reserves the right in its discretion to alter or omit any part of the itinerary or change any space, reservation, feature and/or means of conveyance without notice for any reason whatsoever and without allowance or refund, but the extra cost if any resulting there from must be held responsible for any act, omission, or event during the time passengers are not on board their carriers or conveyance. The passage contract in use by carriers concerned, when issued shall constitute the sole contract between the transportation companies and the purchasers of these tours and/or passengers. All rates are subject to change without notice. We reserve the right to cancel any tour and refund the full amount to the passenger.*

**ALL RATES ARE BASED ON TARIFFS IN EFFECT AT THE TIME THE TOUR WAS PLANNED AND ARE SUBJECT TO CHANGE IN THE EVENT OF AN ADJUSTMENT HEREIN WITHOUT PRIOR NOTICE.**

*This brochure is considered part of the terms and conditions of purchase.*

I (print name) \_\_\_\_\_ agree to the above terms.

Signature: \_\_\_\_\_ Date: \_\_\_\_\_

**TRAVELER'S COPY • Keep for your Records**

NITTANY TRAVEL'S CANCELLATION POLICY:

**\$50 per person in addition to any penalties  
imposed by the vendor.**

**NITTANY TRAVEL; 143-147 East Main Street, Lock Haven, PA 17745**

**Phone: 570-748-6611 OR 800-326-9342 Fax: 570-748-6551 [www.nittanytravel.com](http://www.nittanytravel.com)**

**E-mail: [uter@nittanytravel.com](mailto:uter@nittanytravel.com)**



&



# Christmas in the Heart of Germany

**Avalon Visionary**

**November 29 - December 7, 2012**

<u>Legal Name</u>	<u>Date of Birth (M/D/YY)</u>	<u>Passport # / Expiration</u>
_____	_____	_____/_____
_____	_____	_____/_____
_____	_____	_____/_____
_____	_____	_____/_____

**Street Address:** \_\_\_\_\_

**City, State, Zip:** \_\_\_\_\_

**E-Mail Address:** \_\_\_\_\_

**Home Phone:** \_\_\_\_\_ **Work Phone:** \_\_\_\_\_

**Emergency Contact Name, Phone & Relationship:** \_\_\_\_\_

**Birthdays, Anniversaries, etc.):** \_\_\_\_\_

**Please indicate your cabin category choice. Prices are based on double occupancy:**

- Category E - Request
- Category B - \$2,043 per person
- Category A - \$2,079 per person
- Category P - \$2,150 per person

**Please indicate how you wish to pay your \$500/cabin reservation deposit:** Final Payment due August 10, 2012

<input type="checkbox"/> <b>Personal Check</b>	<input type="checkbox"/> <b>Cash/Money Order</b>
<input type="checkbox"/> <b>Credit Card #</b> _____	<b>Expiration Date:</b> _____
<b>Name of Cardholder:</b> _____	<b>Security Code:</b> _____
<b>Cardholder Signature:</b> _____	

**NITTANY TRAVEL STRONGLY RECOMMENDS THE PURCHASE OF TRAVEL INSURANCE:**

*Travel insurance is available and highly recommended. Ask Ute for further details.*

- I/We wish to purchase travel insurance.
- I/We decline to purchase travel insurance.

**Signature(s)**

**~~PLEASE TURN OVER AND COMPLETE OTHER SIDE~~**

**Please indicate how you heard about this trip:**

- |  |  |
|--|--|
| <input type="checkbox"/> Past Traveler with this Group     | <input type="checkbox"/> Newspaper Ad—paper: _____ |
| <input type="checkbox"/> Past Traveler with Nittany Travel | <input type="checkbox"/> Radio Ad—station: _____   |
| <input type="checkbox"/> Word of Mouth                     | <input type="checkbox"/> Nittany Travel website    |
| <input type="checkbox"/> Travel Agent: _____               | <input type="checkbox"/> Other: _____              |

**Travel Documents:**

***You are responsible for obtaining all travel documents as well as compliance with Customs and Immigration responsibilities. You will be required to comply with all security measures imposed by governments, which may change from time to time. We will endeavor to provide you with notice of measures which may affect you, but complying with any such requirements is your responsibility. All travelers will need proof of citizenship, such as state-issued birth certificate with a raised seal plus a photo I.D. or valid passport.***

**Responsibility:**

*Nittany Travel, operator of the tour herein outlined, its subsidiaries and/or its associated agents act as agents only for all services and disclaim any liability for property loss or damage and/or any loss of services which may be sustained on account, or arising out of, by reason of or while engaged on any tour whether due to ownership, maintenance use, operation or control of any automobile, bicycle, boat, vehicle, inn, common carrier, or otherwise caused by failure or delay or by any transportation company due to any cause whatsoever occurring during a tour under its management, sponsorship, procurement or otherwise. All tickets, coupons, and orders are furnished and issued subject in all respects to these terms and conditions and to any and all terms and public carriers for whom Nittany Travel acts solely as agent. Nittany Travel reserves the right in its discretion to alter or omit any part of the itinerary or change any space, reservation, feature and/or means of convenience without notice for any reason whatsoever and without allowance or refund, but the extra cost if any resulting there from must be held responsible for any act, omission, or event during the time passengers are not on board their carriers or conveyance. The passage contract in use by carriers concerned, when issued shall constitute the sole contract between the transportation companies and the purchasers of these tours and/or passengers. All rates are subject to change without notice. We reserve the right to cancel any tour and refund the full amount to the passenger.*

**ALL RATES ARE BASED ON TARIFFS IN EFFECT AT THE TIME THE TOUR WAS PLANNED AND ARE SUBJECT TO CHANGE IN THE EVENT OF AN ADJUSTMENT HEREIN WITHOUT PRIOR NOTICE.**

*This brochure is considered part of the terms and conditions of purchase.*

I (print name) \_\_\_\_\_ agree to the above terms.

Signature: \_\_\_\_\_ Date: \_\_\_\_\_

**NITTANY TRAVEL'S COPY**

**NITTANY TRAVEL CANCELLATION POLICY:**

*Nittany Travel charges a \$50 per person (\$250 per person inside 60 days) cancellation fee in addition to any fees imposed by the travel vendor.*

**NITTANY TRAVEL; 143-147 East Main Street; Lock Haven, PA 17745  
Phone: 570-748-6611 OR 800-326-9342 Fax: 570-748-6551 [www.nittanytravel.com](http://www.nittanytravel.com)**